



## a modern solution for instant barricades & temporary walls.

Sometimes you need some space—create your own with modular temporary walls. Lightweight, intuitive, and efficiently assembled (or disassembled) without specialized tools, this modular wall system is made to respond to an evolving retail environment, business model, or changing workspace.

Available in 2-foot increments (up to 16ft) for standardized formatting, temporary walls can easily conform to the shape or design of your envisioned space. Made from durable material and with reusable application, these temporary partition

walls are a viable and cost-effective alternative to soon-to-be discarded plywood or expensive and labor-intensive drywall. A modular wall system that is ideal for cordoning off construction, reimagining retail space, and shaping a small business or office atmosphere, temporary walls can shape the interior your business requires.

### TOP PRODUCT BENEFITS:

- SETS UP 3X FASTER THAN DRYWALL
- MODULAR, ADAPTABLE, REUSABLE
- NO DUST, NO PAINTING, NO WASTE

Inventory Number	(Part #)	Item Description	Page #
70001	(355-01)	Square Post	3
	(355Z-01)	Square Rail	3
70004	(1000)	MDF Panel 7/32" x 97" White Hot	11
71000	(651-08)	Head Screw M6 x 8mm	6
71001	(625-10)	PIN M6	5
71002	(625-20)	Hammer Screw	5
71003	(407-01)	Standard Connector Bolt	4
71004	(406-20)	"H" Cap Gray	4
71005	(406-21)	End Plug, Gray Small Cylinder	4
71006	(534-01)	End Cap, Gray Square	5
71007	(407-30)	Coil Spring	4
71008	(407-25)	Standard Bushing 18mm	4
71009	(500-00)	Set Screw for Standard Bushing	4
71010	(386B-01)	U Bracket	3
71011	(902-00)	Continuous Hinge Bracket	6
71012	(905-00)	Flat Bracket	10
71013	(906-00)	Small Base L Bracket	10
71014	(907-00)	Large Corner L Bracket	10
71015	(901-00)	Stainless Door Handle	6
71016	(791-11A)	Aluminum Door Hinge	6
71017	(416-00)	Door Hinge Back Plate	6
71018	(739G-01)	Threshold Plate	7
71019	(640M)	Groove Guide	5
71020	(345-01)	Rectangular Post	8
	(345Z-01)	Rectangular Rail	8
71021	(407-20)	Plastic Insert	9
71022	(739N)	Steel Bracket, Threshold	5
71023	(737A)	Locking Door Handle	7
71024	(504)	4mm Screw Driver	5
N/A	(384-01)	Door Stop	7
N/A	(650-08)	M4 x 8mm Screw	5

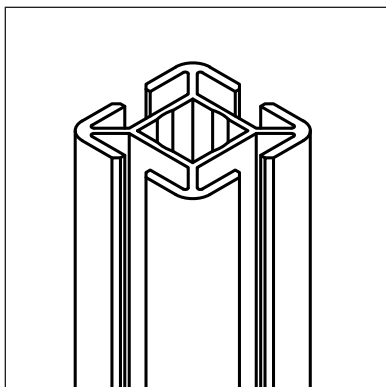

Square Post	Part No. 355-01
Sizes:	1 <sup>3</sup> / <sub>16</sub> " x 1 <sup>3</sup> / <sub>16</sub> "
	Any heights available to max of 16'

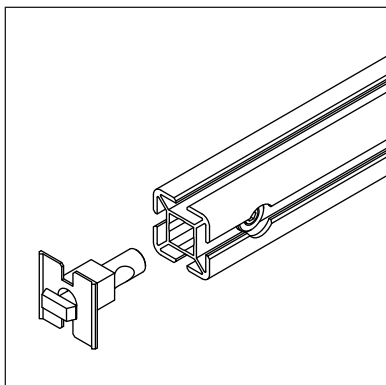



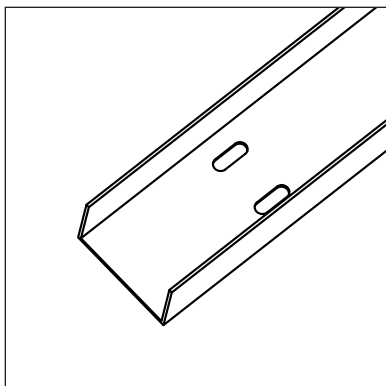

Square Rail	Part No. 355Z-01
Sizes:	1 <sup>3</sup> / <sub>16</sub> " x 1 <sup>3</sup> / <sub>16</sub> "
Includes:	355 Extrusion (2) 355 Connector Assembly
	Custom sizes available (includes Connector)

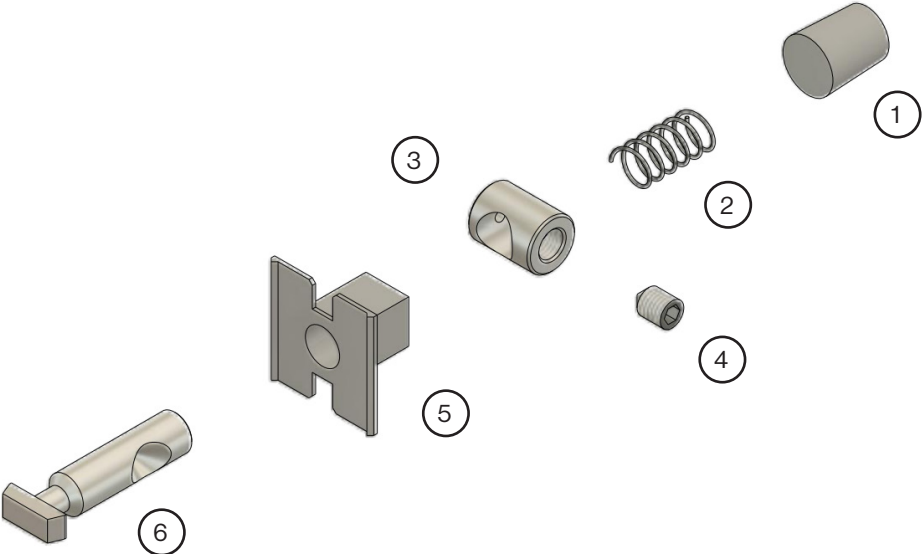

U-Bracket	Part No. 386B-01
Sizes:	1 <sup>3</sup> / <sub>16</sub> " x 2 <sup>3</sup> / <sub>8</sub> " x 30"
Fastener:	(6) 625 Hammer Screw and Pin (required for installation)

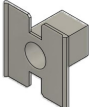
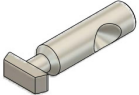

355 Rail / Individual Connector Parts			
1	End Plug, Gray Small Cylinder	Part No. 406-21	
2	Coil Spring	Part No. 407-30	
3	Standard Bushing 18mm	Part No. 407-25	
4	Set Screw for Standard Bushing	Part No. 500-00	
5	Plastic "H" Insert (inside)	Part No. 406-20	
6	Standard Connector Bolt	Part No. 407-01	

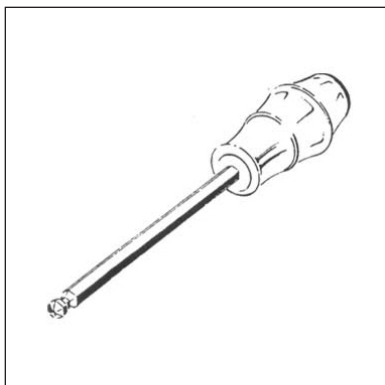

**4mm Screwdriver**

**Part No. 504-00**

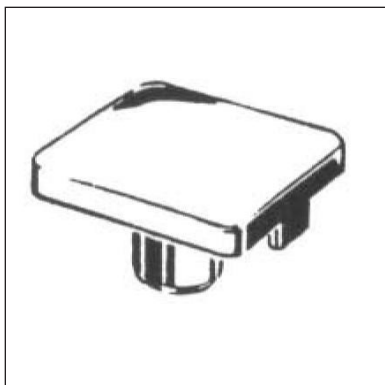

**Plastic End Cap**

**Part No. 534-01**

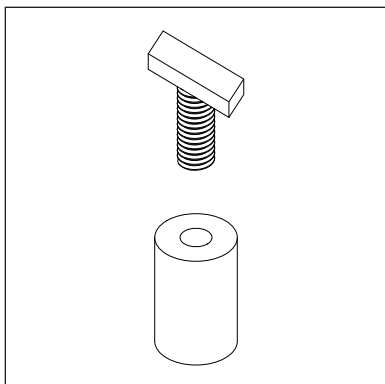

**Hammer Screw & Pin**

**Part No. 625-00**

**Hammer Screw**

**Part No. 625-10**

**Pin M6**

**Part No. 625-20**

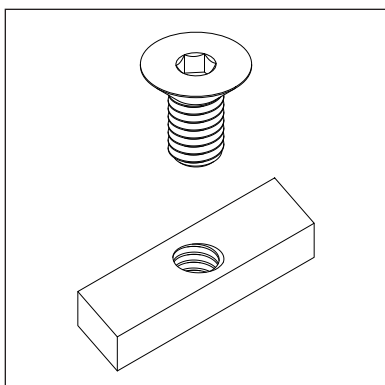

**Groove Guide**

**Part No. 640-00**

**Steel Groove Guide**

**Part No. 640M**

**M4 x 8mm Screw**

**Part No. 650-08**

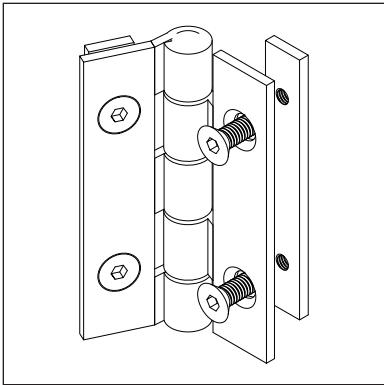

<b>Aluminum Door Hinge</b>	<b>Part No. 791</b>
<b>Door Hinge Back Plate</b>	(2) 416-00 Back Plate
<b>Head Screw M6-1.0 x 6mm</b>	(4) 651-08

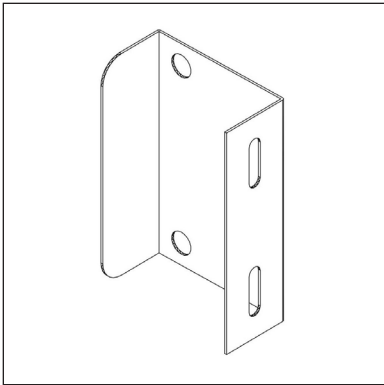

<b>Standless Door Handle</b>	<b>Part No. 901-00</b>
<b>Fastener:</b>	(2) 625 Hammer Screw and Pin (required for installation)

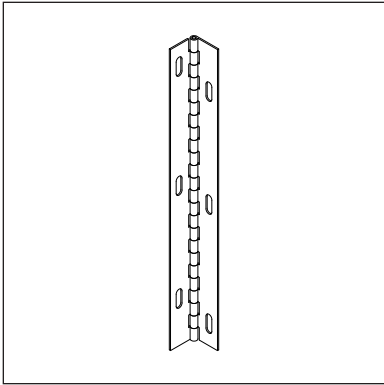

<b>Continuous Hinge Bracket</b>	<b>Part No. 902-00</b>
<b>Size:</b>	12"
<b>Fastener:</b>	(6) 625 Hammer Screw and Pin (required for installation)

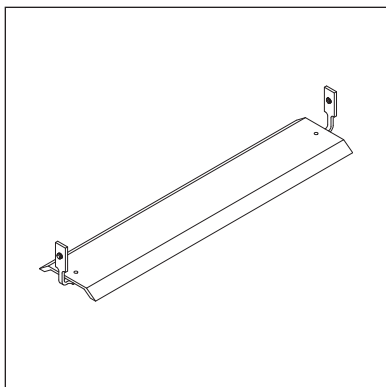

Threshold Plate	Part No. 739
	Full Assembly Includes 739G-01 Threshold Plate and (2) 739-N Bracket
	(2) M6 x 8mm Screws

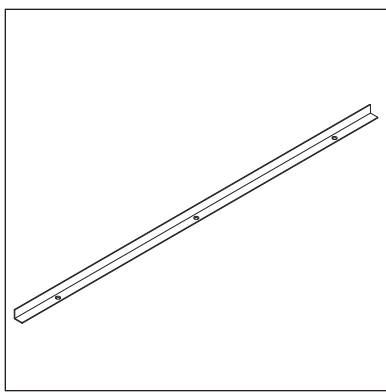

Door Stop	Part No. 384-01
	(3) 640M Groove Guide
	(2) M6 x 8mm Screws

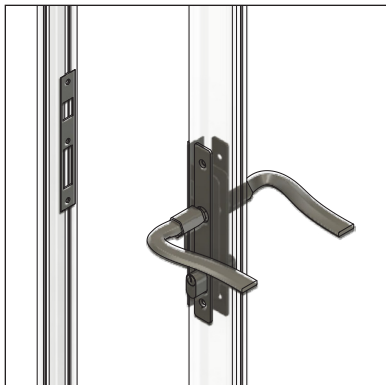

Locking Door Handle	Part No. 737A
	Used In: 355 Door Striker Post and 345 Door Latch Post
	Screws

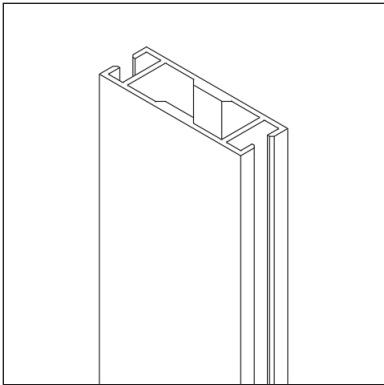



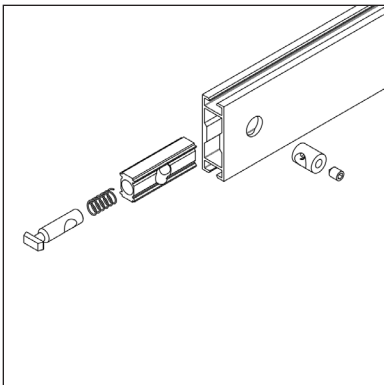

Rectangular Post	Part No. 345
Size:	20mm x 60mm

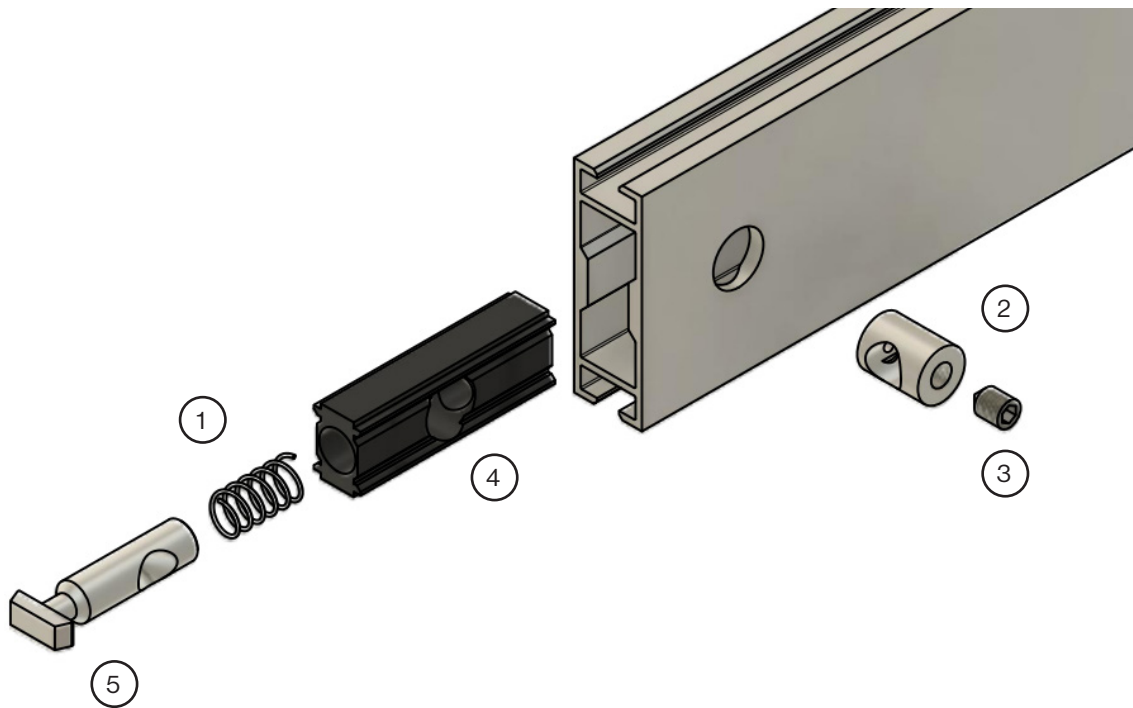

Rectangular Rail	Part No. 345Z-01
Size:	
	Includes 345 Extrusion and 345 Connector Assembly

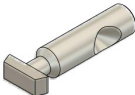

345 Rectangular Post / Individual Connector Parts			
1	Coil Spring	Part No. 407-30	
2	Standard Bushing 18mm	Part No. 407-25	
3	Set Screw for Standard Bushing	Part No. 500-00	
4	Plastic Insert	Part No. 407-20	
5	Standard Connector Bolt	Part No. 407-01	

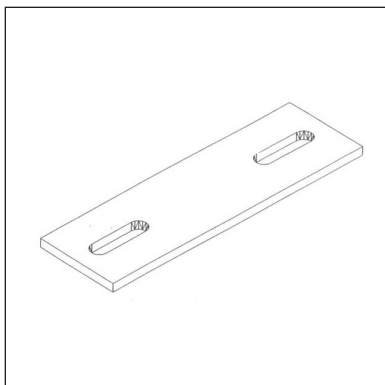

Flat Bracket	Part No. 905-00
Size:	4" x 1 <sup>3</sup> / <sub>16</sub> "
Fastener:	(2) 625 Hammer Screw and Pin

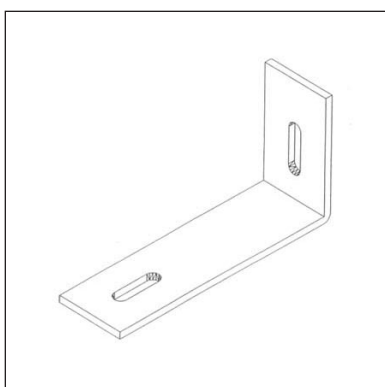

Small Base L Bracket	Part No. 906-00
Size:	2" x 4" x 1 <sup>3</sup> / <sub>16</sub> "
Fastener:	(2) 625 Hammer Screw and Pin

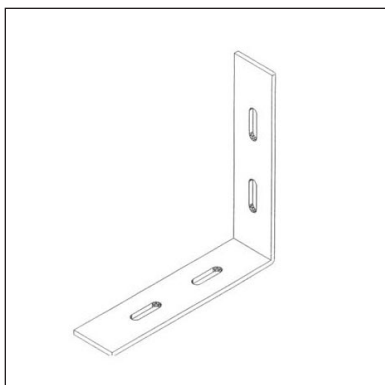

Large Corner L Bracket	Part No. 907-00
Size:	5" x 5" x 1 <sup>3</sup> / <sub>16</sub> "
Fastener:	(4) 625 Hammer Screw and Pin



MDF White Vinyl Laminated Both Sides	Part No. 1000-00
Size:	46 <sup>3</sup> / <sub>16</sub> " x 46 <sup>7</sup> / <sub>8</sub> "
Custom Sizes Available	



6mm Sintra Outdoor Usage	Part No.
Size:	46 <sup>3</sup> / <sub>16</sub> " x 46 <sup>7</sup> / <sub>8</sub> "
Custom Sizes Available	



6mm Acrylic Window	Part No.
Size:	46 <sup>3</sup> / <sub>16</sub> " x 46 <sup>7</sup> / <sub>8</sub> "
Custom Sizes Available	

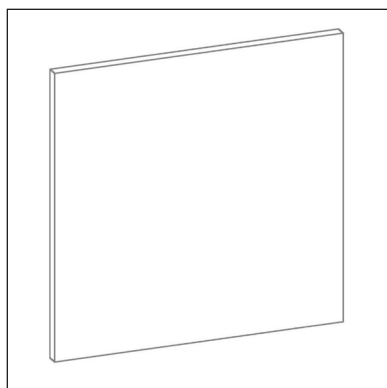

Polysorb (Sound Dampening)	Part No.
Custom Sizes Available	