

YOU DO THE BEER. WE DO THE BUILD.

FLEXIBLE. MOBILE. SETS UP JUST ABOUT ANYWHERE FAST and lets you configure your serving space anyway you want—custom bars, lighted awnings, coolers, kegerators, sinks. Plumb for running water. Wire for sound systems and large-screen TVs. If you can dream it, BoxPop® can build, deliver, and even install it.

- Get your custom structure delivered in weeks, not months
- Insist on BoxPop® one-trip containers, the best grade on the market
- Rent or purchase with competitive pricing
- Available in 10', 20', and 40' modular units, and custom configurations
- Warrantied for one year



BOXPOP® 10 BREW PUB

Easy to transport. Quick to offload. Sets up fast in the smallest footprint yet delivers plenty of elbow room for your workers and social-distancing customers. Expand your serving capacity into the parking lot outside your current business. Test a new location across town. Our smallest mobile unit strikes a perfect balance of mobility, utility, cost benefit, and space to keep serving long after the competition has run dry.



TECHNICAL SPECS

First Level Floor Space: 10' x 8'

Additional Doors-Down Space: 7' x 8'

Weight: 4,500 lbs.

Standard Features Included: Custom paint system, flip up awning serving window, electrical infrastructure and LED lighting, handwash sink with plumbing rough-in, seamless vinyl flooring.

Base Price: \$50,000

Popular Add-Ons: Mechanical cooling and heating unit, exhaust fan, bar equipment package, automatic awnings, wall insulation and wall panels, misting machines, bar-height seating, sound system.

Transport: Full size capacity pickup

BOXPOP® 20 BREW PUB

Meet the Gold Standard of shipping containers sized for full-service wineries, eateries, and mobile taprooms. Delivers twice the space of a food truck at a similar cost. Eye-catchingly cool and infinitely customizable—every square inch, even the roof. Blow the roof off run-of-the-mill wine service with the BoxPop 20, a mobile business platform with a brick-and-mortar feel and open-air comfort for customers looking to avoid cramped indoor spaces and crowds.



TECHNICAL SPECS

First Level Floor Space: 20' x 8'

Second Level Floor Space: 24' x 8'

Additional Doors-Down Space: 192 sq. ft.

Weight: 7,500 lbs.

Standard Features Included: Custom paint system, flip up awning serving window, electrical infrastructure and LED lighting, handwash sink with plumbing rough-in, vinyl plank flooring.

Base Price: \$65,000

Popular Add-Ons: Rooftop deck with stairs, mechanical cooling/heating unit, exhaust fan, bar equipment package, automatic awnings, wall insulation and walls panels, misting machines, bar-height seating, sound system.

Transport: Large capacity pickup (3500 or higher)

BOXPOP® DOUBLE 20 BREW PUB

More backbar space. More service windows. More room inside for bartending staff (6-8). Keep pace with large, thirsty crowds with the newest addition to the BoxPop fleet. Built specifically for three-window bar and taproom service, this hybrid design uses an exclusive clamp-and-seal system to join two 20' containers together. Breaks down for transport. Fits into compact footprints—small parking lots, community parks, downtown districts—where a standard, long 40' container can't.

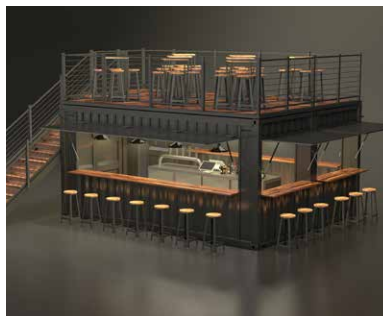

TECHNICAL SPECS

First Level Floor Space: 20' x 16'

Second Level Floor Space: 24' x 16'

Additional Doors-Down Space: 384 sq. ft.

Weight: 14,000 lbs.

Standard Features Included: Custom paint system, flip up awning serving window, electrical infrastructure and LED lighting, handwash sink with plumbing rough-in, vinyl plank flooring.

Base Price: \$145,000

Popular Add-Ons: Rooftop deck with stairs, Mechanical cooling and heating unit, exhaust fan, bar equipment package, automatic awnings, wall insulation and walls panels, misting machines, bar-height seating, sound system.

Transport: Large capacity pickup (3500 or higher)

BOXPOP® 40 BREW PUB

All the benefits of a brick-and-mortar location without the Main Street overhead. From full-on commercial kitchens for food and wine service to seating options for customers indoors and out.

Create an unforgettable space for your customers that represents your unique brand. The largest custom container in the BoxPop fleet delivers a no-limits option that combines mobility, a massive amount of indoor space, and an industrial look that turns heads.

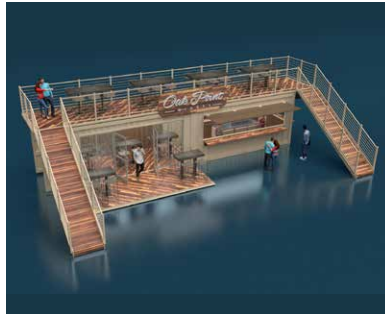

TECHNICAL SPECS

First Level Floor Space: 40' x 8'

Second Level Floor Space: 44' x 8'

Additional Doors-Down Space: 256 sq. ft.

Weight: 10,500 lbs.

Standard Features Included: Custom paint system, flip up awning serving window, electrical infrastructure and LED lighting, handwash sink with plumbing rough-in, vinyl plank flooring.

Base Price: \$95,000

Popular Add-Ons: Rooftop deck with stairs, mechanical cooling and heating unit, exhaust fan, bar equipment package, automatic awnings, wall insulation and wall panels, misting machines, bar-height seating.

Transport: Large capacity pickup truck (3500 or higher) or semi truck and trailer.

