

ATTENTION!

safety instructions

1. Read all instructions and safety information before installing BannerDrop™.
2. Installation work must be done by qualified person(s) in accordance with all applicable state and local codes and standards.
3. Use this unit only in the manner intended by the manufacturer. If you have any questions, contact the manufacturer.
4. Install BannerDrop™ securely with the provided swaged cables and/or according to local regulations. Confirm the structure used to support a BannerDrop™ unit and its load is fully capable of supporting the system. Where structural specifications are not available, the limitations assigned to the environment shall be based on the determinations of a qualified engineer.
5. The BannerDrop™ system should be installed INDOORS ONLY unless optional cover is used.
6. Only use BannerDrop™ for the purpose of raising and lowering advertising articles of equal or lesser weight than the units maximum load rating.
7. Never use or attempt to use a BannerDrop™ to support a person or persons.
8. Never use BannerDrop™ to perform any function that will introduce a side pull to the unit, such as pulling a load

WARNING!

This product is designed to use only those parts supplied with this product and/or any accessories designated specifically for use with this product by Britten, Inc. Substitution of parts or accessories not designated for use with this product by Britten, Inc. could result in personal injury or property damage.

bannerdrop™ parts list

- A. one BannerDrop™ unit (includes weight bar, 60' lift cable)
- B. one remote control
- C. four 10" wire rope assemblies
- D. two 60" wire rope assemblies
- E. four D-Shackles
- F. four togglers
- G. four eye bolts
- H. four large 1/4" washers
- I. four medium 1/4" washers
- J. four 1/4" lock washers
- K. four 1/4" wing nuts
- L. mounting template

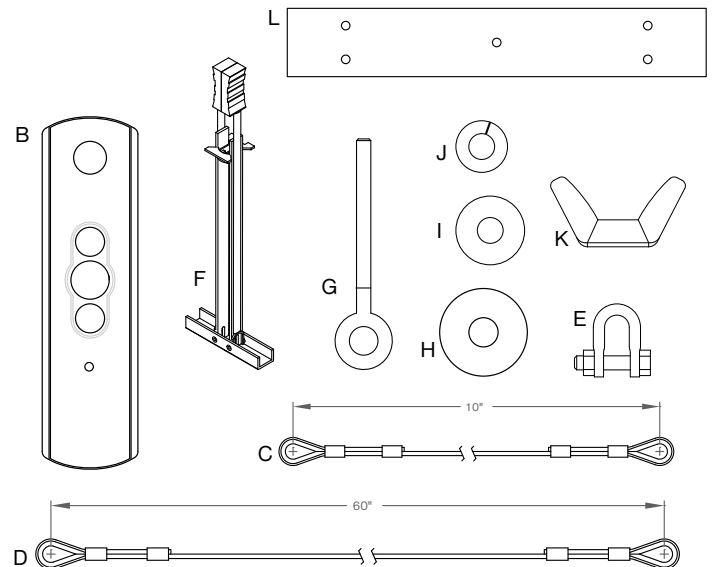
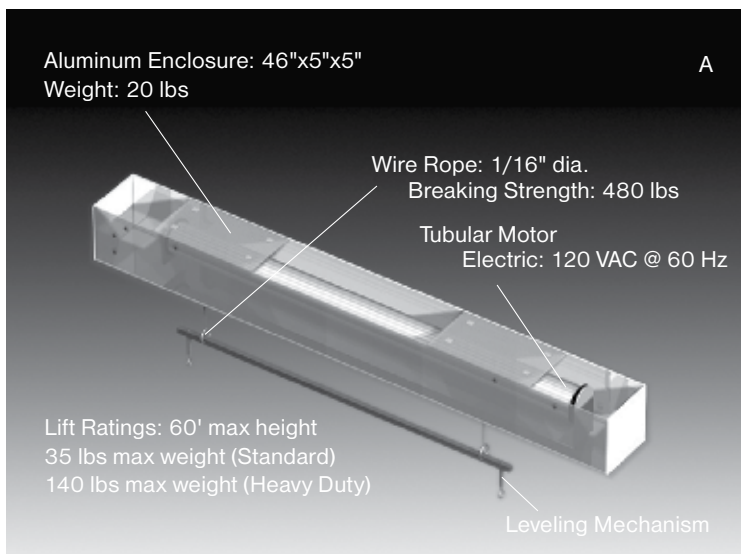

NOTE

Unit should be mounted within 10 feet of a 115 volt AC electrical outlet. Read all Safety Instructions prior to installing BannerDrop™.

open ceiling installation *(Refer to Diagram A for the following)*

1. Attach 10" wire rope assemblies to threaded studs using wingnut, medium washer and lock washer.
2. Connect 10" wire ropes together in sets at each end using D-shackle.
3. Wrap both 60" wire rope assemblies around structural member and secure both ends into D-Shackles.

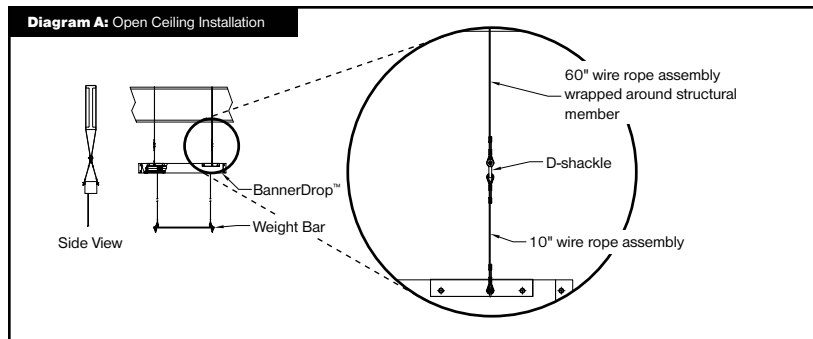

closed ceiling installation *(Refer to Diagram B for the following)*

(Note: Manufacturer recommends anchoring into building structure)

1. Drill four 1/2" holes into hanging surface at desired location using mounting template.
2. Insert metal end of toggler into hole and push the plastic lock up to the ceiling. Cut remaining plastic legs off.
3. Screw eye bolt with large washer into toggler (snug only).
4. Attach one 10" wire rope assembly per threaded stud using wingnut, medium washer and lock washer.
5. Attach one 10" wire rope assembly to each eye bolt with D-Shackle.

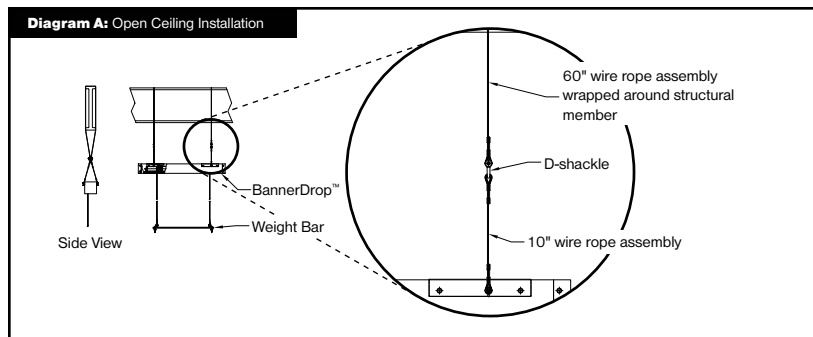

ATTENTION!

NEVER LOWER THE WEIGHT BAR TO THE GROUND. This unweights the cables and can result in the loosening of the cables on the drum.

NEVER RAISE THE WEIGHT BAR UP TO THE BANNERDROP™ UNIT. This causes the motor to strain the wire rope, damaging the unit and rendering it unsafe.

BannerDrop™ motors are equipped with over heat protection. Units should be operated as follows:

- **35 lb capacity:** ON for 2 minutes, OFF for 1 minute
- **140 lb capacity:** ON for 50 seconds, vOFF for 1 minute

REMOTE CONTROL DIAGRAMS

Diagram C: Front

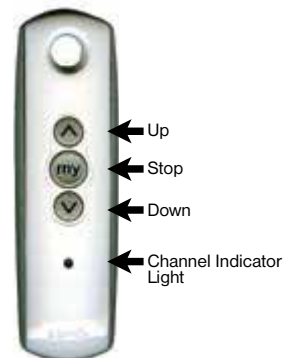

Diagram D: Back





programming the remote

(Refer to Remote Diagrams C & D for the Following)

RECOMMENDED — if a Britten banner is not available, safely hang an additional 2 to 3 pounds of weight from the weight bar using the closed loop hooks while programming your BannerDrop™.

1. Press and hold both UP and DOWN buttons simultaneously until the motor jogs, then release. (A jog is a short down and up movement of the motor).



If the motor jogs up first, then down, change its polarity by pressing and holding the STOP button.

2. Press the DOWN button to lower weight bar a few feet from BannerDrop™ unit to provide a buffer zone while setting positions.

setting the upper and lower positions



Please read entire directions before proceeding to set upper and lower positions.

1. Use UP or DOWN buttons to position the Britten banner in the preferred upper position.
2. Press and hold both STOP and DOWN buttons simultaneously until your Britten banner begins to lower, then release. Use STOP button when your Britten banner is in the preferred lower position. (Adjust if necessary by pressing UP or DOWN buttons).
3. Press and hold both STOP and UP buttons simultaneously until your Britten banner begins to raise, then release. Banner will stop at preferred upper position. Adjust if necessary by pressing UP or DOWN buttons.
4. Press STOP button 5 seconds until motor jogs. The preferred positions are now recorded.
5. Hold PROGRAM button 3 seconds until motor jogs. This locks the BannerDrop™ unit into user mode.

resetting the upper and lower positions (optional)

1. Press UP button to ensure your Britten Banner is raised to its upper position.
2. After motor has stopped, press and hold both UP and DOWN buttons simultaneously until the banner jogs.
3. Using the UP or DOWN buttons, adjust your Britten banner to its new upper position.
4. Record the new upper position by pressing and holding STOP button until the Britten banner jogs.

The new upper position is now reset. If necessary, repeat same procedure to reset the lower position.

setting an intermediate position (optional)

1. Once the limits are set and the BannerDrop™ is in user mode, use UP or DOWN buttons to move your Britten banner to its intermediate position. Press STOP button WHEN banner reaches the preferred intermediate position.
2. Press and hold STOP button 5 seconds until the motor jogs, then release.

Note: To confirm the intermediate position, press UP button to return banner to upper limit. Once the banner is at rest, press STOP button to return to the intermediate position. To lower your Britten banner from the inter-mediate position to its lower position, press DOWN button.

resetting bannerdrop™ to factory mode (optional)

1. Position your Britten banner halfway between the BannerDrop™ and the floor.
2. Perform a DUAL POWER CUT by disconnecting power for 2 seconds, returning power for 10 seconds, disconnecting again for 2 seconds, and then reconnecting power.

Note: The BannerDrop™ motor will rotate in one direction for about 5 seconds.

3. Once the motor stops, press and hold PROGRAM button until it jogs twice, then release. Note: It will take approximately 10 seconds for both jogs to occur, with a pause between.

DO NOT RELEASE PROGRAM BUTTON UNTIL THE SECOND JOG OCCURS OR THE UNIT WILL NOT BE RESET.



operating instructions

1. Plug unit into 115 volt AC outlet.
Refer to Remote Diagram below for the following:
2. To lower banner: Press the DOWN button. Press the STOP button to stop motor at desired height.
3. To raise banner: Press the UP button. Press the STOP button to stop motor at desired height.
4. To reset preferred positions or to add an intermediate position, please refer to the **programming the remote** section of this guide.

Diagram C: Front

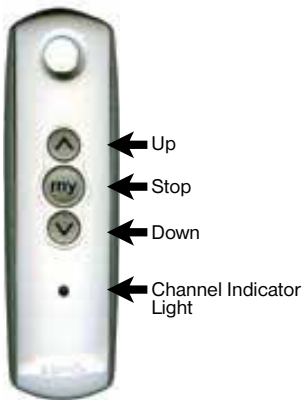

Diagram D: Back



troubleshooting guide

Difficulty in operating BannerDrop™ may be a result of incorrect installation or use. If you experience any faults, please check the Troubleshooting Guide before contacting the manufacturer.

If BannerDrop™ does not operate:

- Check LED indicator to see if unit is receiving power.
- Make sure unit is plugged into outlet.
- If light is off, check main and branch circuit fuses or circuit breakers. c. If light is on, wait ten to fifteen minutes for motor to cool.

If BannerDrop™ weight bar is uneven:

- Keep tension on the cables at all times.
- Follow the “resetting limits” programming procedures to spool both cables out of the BannerDrop™ 60 feet.
Note: *never spool more than 60 feet out as there is a safety stop crimped to the last few feet that can not come out of the unit.*
- Spool the cables back into the unit following the same programming procedures until you are back to your preferred lower limit.

warranty

Britten, Inc. offers a conditional 1-year warranty against product design and manufacturing assuming proper installation and proper operational conditions. During the warranty period, Britten, Inc. will repair or replace the unit. The warranty only applies to the original purchaser and is in lieu of all other warranties expressed or implied for a period of one year from the date of purchase.

Britten, Inc. will not warranty the following: LABOR associated with the removal or installation of the unit; DAMAGE caused by misuse, neglect abuse, accidents, alterations, corrosive environments, and any other abnormal service conditions. Claims against the warranty must include: pictures of the installation; written description of the problem; and return material authorization issues by Britten, Inc.

R-20230420-8594